



PRESLEY'S PLACE

Architecture - Small
Completed July 2019

PROVIDING A SENSORY-FRIENDLY SPACE IN AN AIRPORT ALLOWS PASSENGERS WITH AUTISM OR OTHER "HIDDEN DISABILITIES" TO REGROUP AND TRANSITION PEACEFULLY TO THE NEXT STAGE OF THEIR JOURNEY. THE CLIENT WAS INSPIRED BY AN AIRPORT EMPLOYEE - *JASON RUDGE*. HIS SON PRESLEY HAS AUTISM. PRESLEY HAS ACCESS TO A SENSORY ROOM AT HIS PRESCHOOL SO JASON THOUGHT HAVING A SIMILAR ROOM AT THE AIRPORT COULD MAKE IT EASIER FOR FAMILIES WITH AUTISTIC CHILDREN TO TRAVEL. THE SPACE WAS DESIGNED TO PROMOTE HEALTH AND COMFORT, AND BE OPEN AND AVAILABLE TO ALL.

"a first-of-its-kind sensory space at Pittsburgh International Airport"

CONCEPTUAL DESIGN

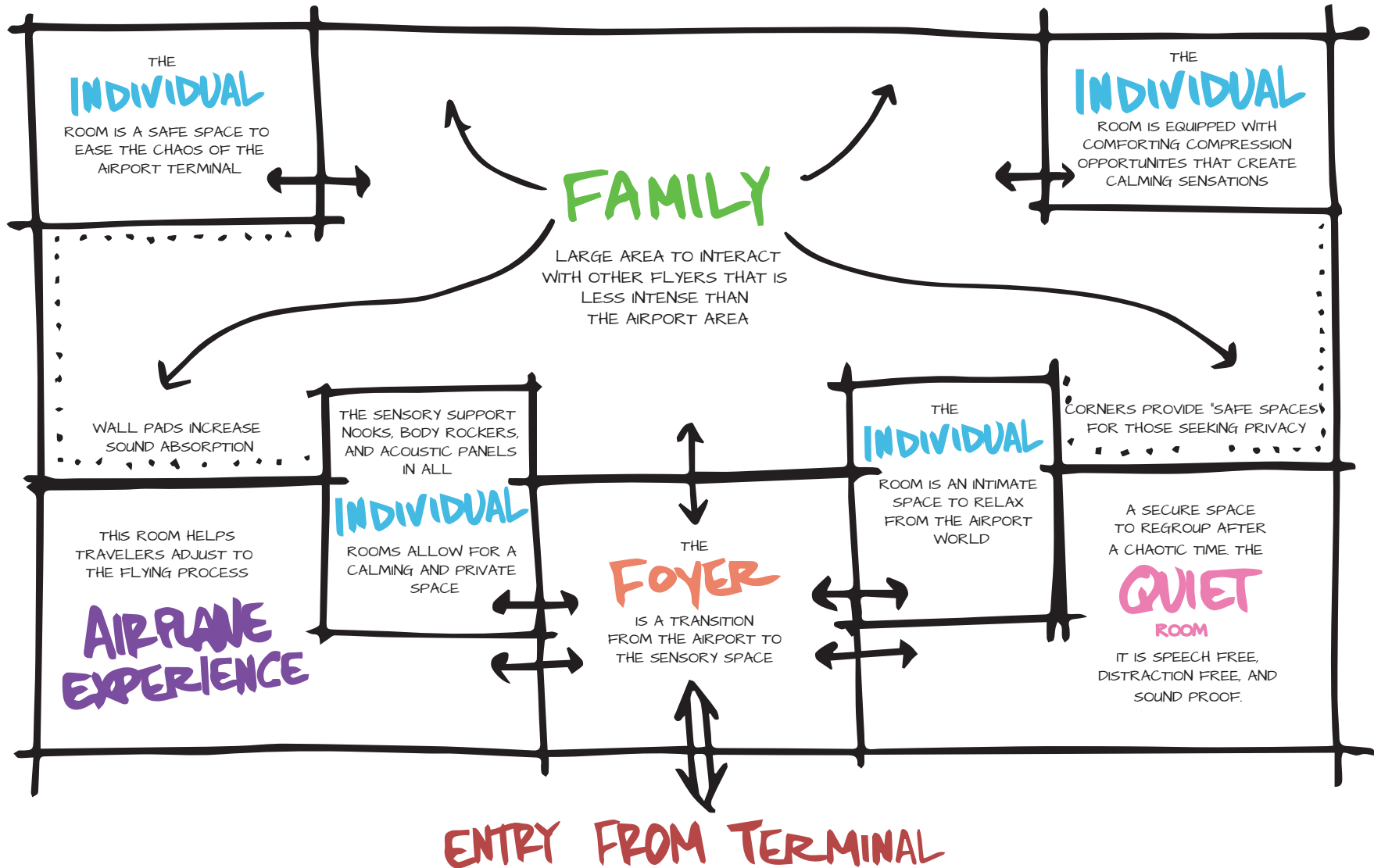

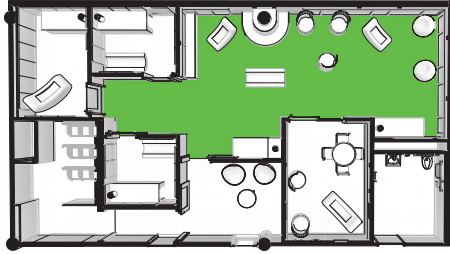

FAMILY ROOM

A SPACE FOR INDIVIDUALS TO **DESENSITIZE FROM THE TERMINAL**. LED LIGHTING IS SOFTENED USING ACRYLIC "CLOUD COVERS." **LOW NOISE LEVELS** ARE ACHIEVED WITH HIGH SOUND ATTENUATING PARTITIONS, HIGH PERFORMANCE ACOUSTIC CEILING PANELS AND, ACOUSTICALLY SEALED SLIDING DOORS. **DISTRACTING ODORS ARE ELIMINATED** BY SPECIFYING MATERIALS THAT DO NOT OFF-GAS OR REQUIRE CLEANERS WITH OVERWHELMING SMELLS.



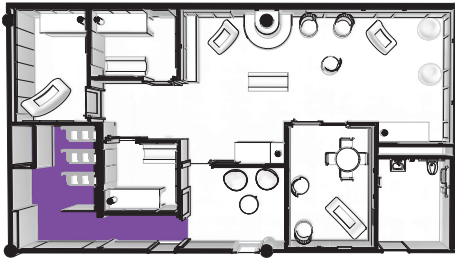

AIRPLANE EXPERIENCE

"SOCIAL STORIES" ARE A LEARNING TOOL USED TO INTRODUCE NEW EXPERIENCES OR PROVIDE GUIDANCE AND DIRECTION FOR STRESSFUL SITUATIONS. THE AIRPLANE EXPERIENCE ROOM PROVIDES USERS WITH THE OPPORTUNITY TO **EXPERIENCE** WALKING DOWN THE JET WAY, **GETTING ONTO AN AIRPLANE**, TAKING A SEAT, AND BUCKLING IN FOR THE JOURNEY.



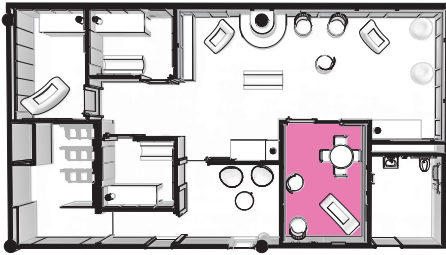

QUIET ROOM

TOO MUCH STIMULATION CAN LEAD TO HYPER-FOCUS ON THOSE ITEMS INSTEAD OF CALMING DOWN AND PREPARING FOR TRAVEL. THE QUIET ROOM IS SILENT. FABRIC WRAPPED AND CORK WALL PANELS ADDRESS THE ACOUSTICS OF THE SPACE.

RUBBER BACKED VINYL FLOORING REDUCES THE RISK OF INJURY, OFFERS SOUND CONTROL, AND COMFORT UNDERFOOT

ACOUSTIC WALL PANELS ARE MADE FROM RECYCLED CORK AND LIMIT SOUND REFLECTION

BODY ROCKER THERAPY CHAIR ALLOW GENTLE MOVEMENT IN SUPPORT OF VESTIBULAR STIMULATION

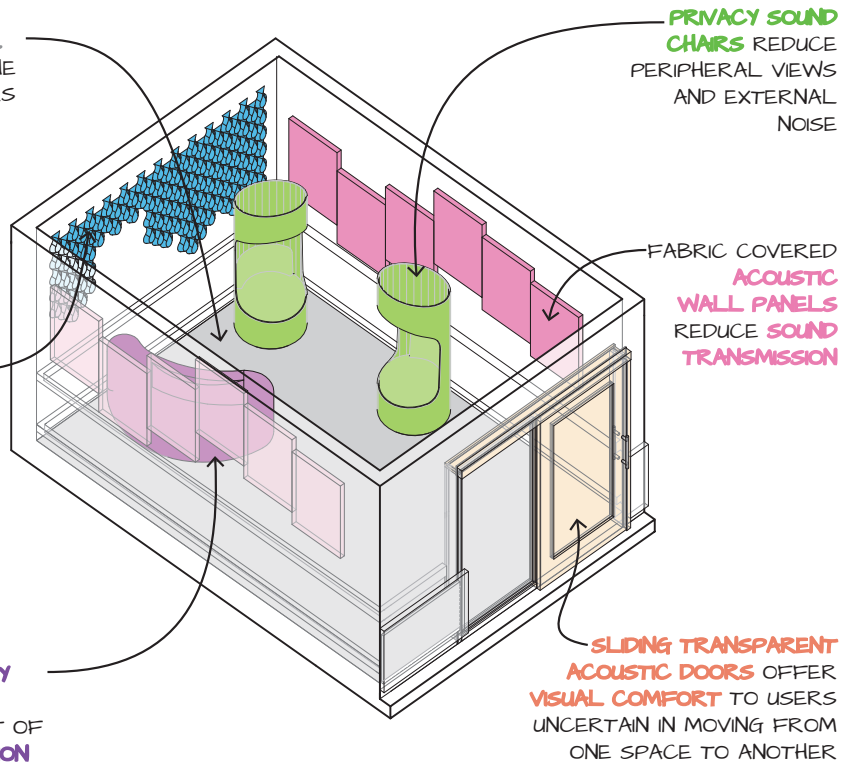

PRIVACY SOUND CHAIRS REDUCE PERIPHERAL VIEWS AND EXTERNAL NOISE

FABRIC COVERED ACOUSTIC WALL PANELS REDUCE SOUND TRANSMISSION

SLIDING TRANSPARENT ACOUSTIC DOORS OFFER VISUAL COMFORT TO USERS UNCERTAIN IN MOVING FROM ONE SPACE TO ANOTHER



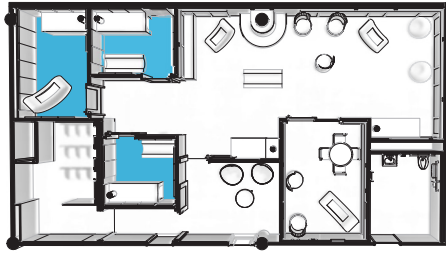

INDIVIDUAL ROOM

AUTISTIC BRAINS NEED REST AND DOWNTIME. THE "INDIVIDUAL ROOMS" CONTAIN FEWER STIMULI AND PROVIDE EXTRA PRIVACY. THEY ARE EQUIPPED WITH MINIMAL FURNITURE, PADDED WALLS, AND CUSHIONED FLOORS OFFERING PROTECTION FOR THOSE WITH SELF-HARMING TENDENCIES.

CUSTOM **SENSORY SUPPORT NOOKS** PROVIDE RELAXATION AND COMPRESSION

WALL PADS AND CUSHIONED FLOORS ALLOW USERS TO **RELEASE ANXIETY OR AGGRESSION** WITHOUT HARMING THEMSELVES

BODY ROCKERS PROVIDE THE OPPORTUNITY TO STRETCH, LAY, OR ROCK TO **ACHIEVE CALMING SENSATIONS**

PARTITIONS ARE CONSTRUCTED WITH MULTIPLE DRYWALL LAYERS AND RESILIENT SOUND ISOLATION CLIP SYSTEMS FOR SOUND ATTENUATION

FABRIC COVERED **ACOUSTIC WALL PANELS** LIMIT SOUND TRANSMISSION

SLIDING TRANSPARENT ACOUSTIC DOORS PROVIDE EASY OPERATION AND ALLOW USERS TO **ANTICIPATE WHAT IS ON THE OTHER SIDE**

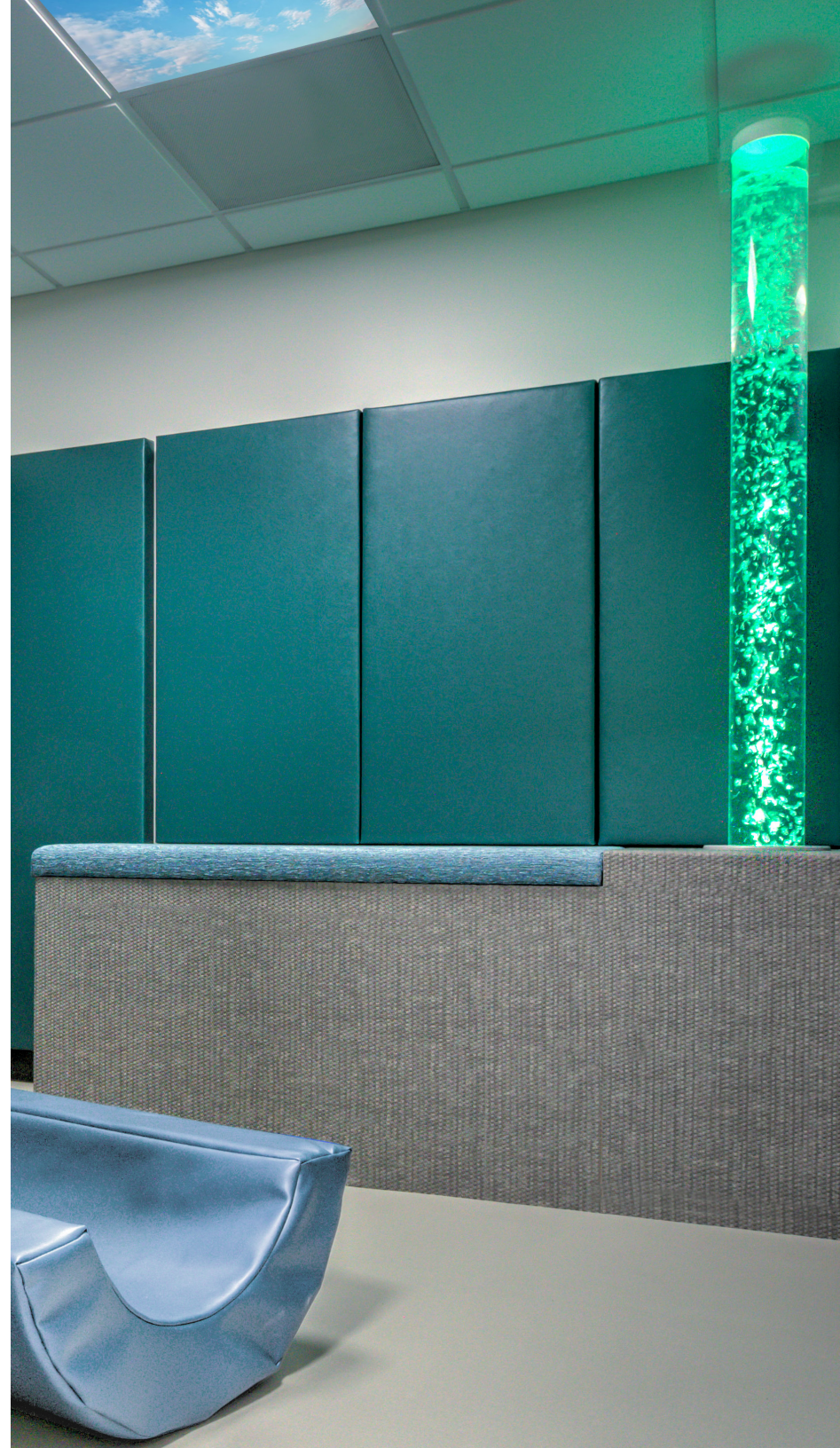



CUSTOM DESIGNED SENSORY SUPPORT NOOKS

CARPET FINISH ON
LAMINATED PLYWOOD
PROVIDES **SOFT**
SURFACE TEXTURE

FRAMING AND
PLYWOOD RIB
STRUCTURE

LOCKABLE
CABINETS PROVIDE
ACCESS FOR
MAINTENANCE OF
BUBBLE TUBE,
POWER SUPPLIES,
CONTROLLER,
AND **FIBER-OPTIC**
CARPET POWER

EXPOSED SURFACES ARE
COVERED WITH **MOLD AND MILDEW**
RESISTANT CARPET ADHERED WITH A
LOW VOC ADHESIVE

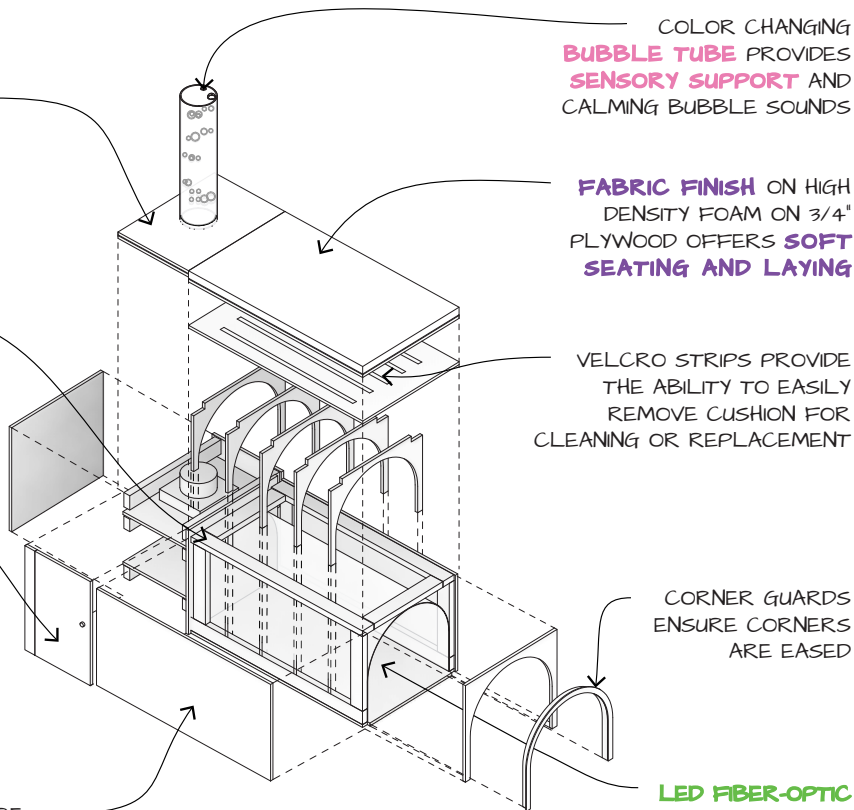

COLOR CHANGING
BUBBLE TUBE PROVIDES
SENSORY SUPPORT AND
CALMING BUBBLE SOUNDS

FABRIC FINISH ON HIGH
DENSITY FOAM ON 3/4"
PLYWOOD OFFERS **SOFT**
SEATING AND LAYING

VELCRO STRIPS PROVIDE
THE ABILITY TO EASILY
REMOVE CUSHION FOR
CLEANING OR REPLACEMENT

CORNER GUARDS
ENSURE CORNERS
ARE EASED

LED FIBER-OPTIC
TUNNEL ENCOURAGES
EYE TRACKING AND
VISUAL STIMULATION.



SUSTAINABILITY AND MATERIALITY

THE **NEEDS OF THE INTENDED USERS** DICTATED A STRONG EMPHASIS ON THE USE OF LABELED **SUSTAINABLE PRODUCTS**.

CEILING, PAINTS, FLOORING, WALL PADS, AND ACOUSTIC WALL TREATMENTS HAVE **VARIOUS CERTIFICATIONS**. OFFERING A VARIETY OF TACTILE SURFACES ON THE WAINSCOT HELPS THOSE WITH **TACTILE AVOIDING** OR SEEKING BEHAVIORS TO DEVELOP EMOTIONAL SECURITY, SOCIAL SKILLS, AND ACADEMIC LEARNING.

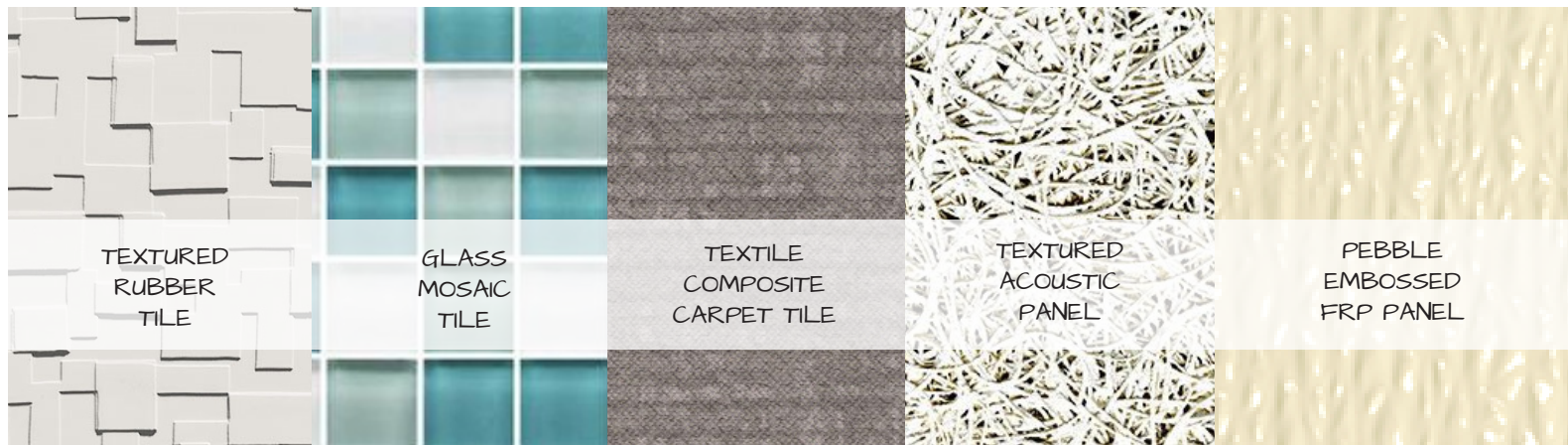
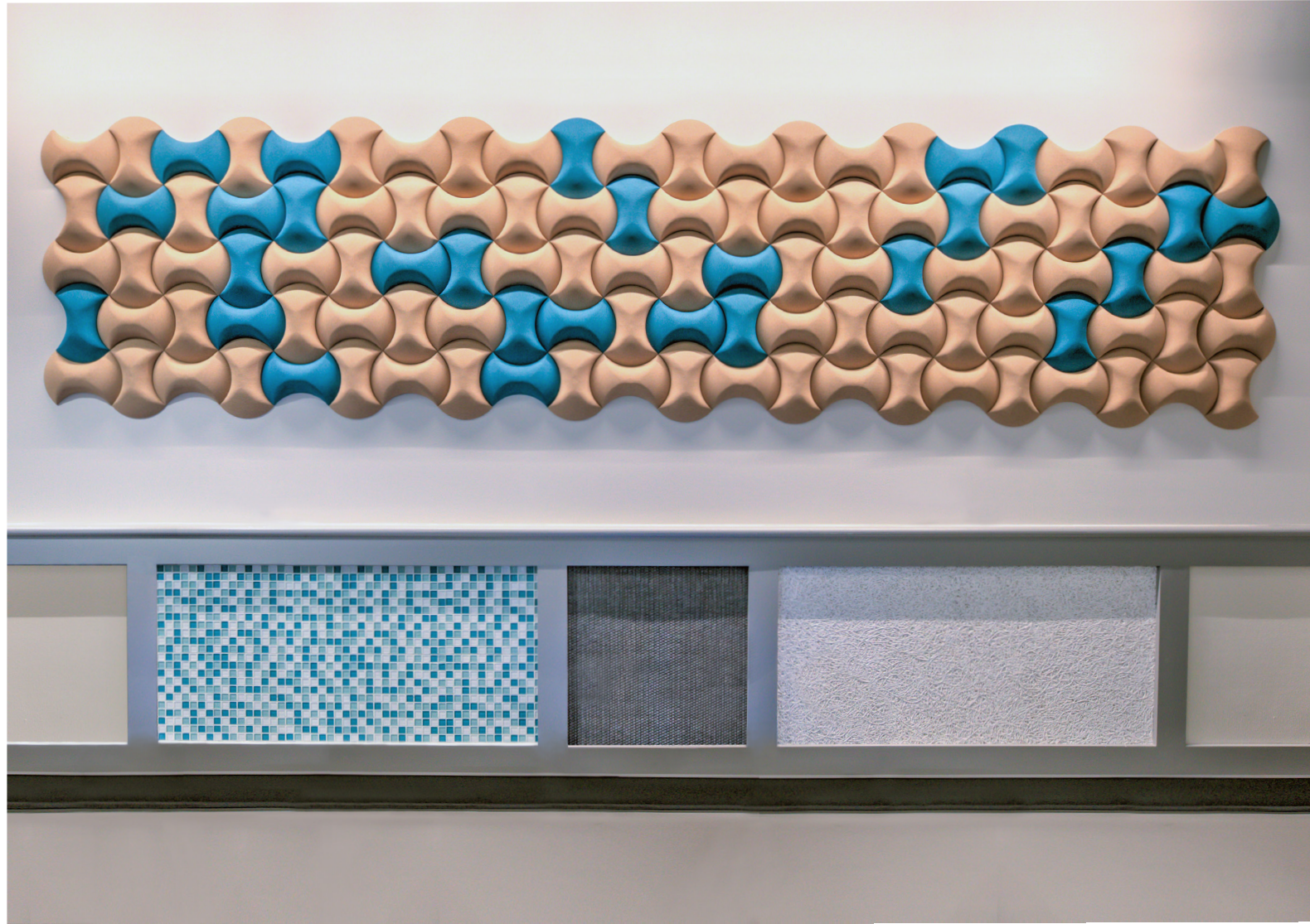



" A CAREGIVER FOR A KID WITH
AUTISM MIGHT THINK, ' I'M NEVER
GOING TO BE ABLE TO FLY
ANYWHERE WITH MY FAMILY -
IT'S TOO HARD TO TRAVEL WITH
SOMEONE WITH AUTISM.' HAVING
A SENSORY ROOM AT THE
AIRPORT CHANGES THAT THINKING
TO, 'MAYBE WE CAN TAKE
THAT TRIP AFTER ALL. ' "

- JASON RUDGE